



adhésion bellows
 membranes moulding joints
 giunti gomma plastométer
 MODELLO Blasebälge

A LONG-TERM COMMITMENT



GLOBAL OFFER

EFJM is specialized in the design and development of sealing systems for the aeronautical, military and pneumatic fields, as well as packaging machines for liquid, viscous and pasty products.

These sealing systems are customized according to customer specification and comply with the requirements of their environment.



CONTROL OF ELASTOMERS

The R & D team offers its expertise and experience to solve all sealing problems:

- PTFE/rubber/stainless steel composite pistons
- PTFE/rubber/stainless steel liners
- PTFE/composite guiding seals
- dosing membranes by deformation

The optimum utilization of sealing systems in their work environment will depend on the quality of the elastomers. EFJM has developed rubber formulas specifically adapted to the utilization of the end product and has a laboratory with the equipment required to control the physico-chemical characteristics of the elastomers. It maintains an on-hand stock to effectively and promptly satisfy the different specific requests of customers.

Rubber is a mechanical building material with viscoelastic properties which we use to give to PTFE a "spring" effect so that it can keep the friction area (lip) in contact with the lining.

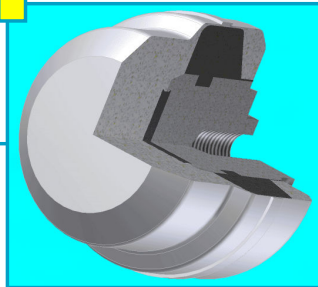

EFJM, News

Pushed by the ever increasing requirements that any small or medium sized company in full expansion encounters, EFJM has placed durable development at the heart of its industrial strategy. For this reason, EFJM globalizes its manage-

ment by giving it a universal character. In an ongoing progress approach, our company asserts its commitments in many fields: security, safety, environment, technological performance, human resources, dialog with partners and economic development.

SPECIALIST IN THE DESIGN AND DEVELOPMENT OF SEALING FUNCTIONS

www.efjm.com - +33 (0)2 32 58 10 09





A long-term commitment



In order to provide meaning and a future for coming generations, without a shadow of a doubt sustainable development constitutes a challenge and a necessity for our planet.

Being aware of its responsibilities in relation to its shareholders, customers, employees and partners, our company is deploying its development approach through specific commitments which concretise its ambition to achieve profitable growth that is socially responsible and environmentally friendly.

The consistency of this approach is shown through the ongoing initiatives, under the framework of plans for improvements and validated organisational systems. Disseminated and applied, they incorporate our quality management system with a view to becoming our sole management system by 2008.

In the field of **Quality**, it is of utmost importance to gain the total satisfaction of our customers. Permanently reach confor-

mity for the delivered products and the associated services. Increase the technological content of our products while respecting standards & regulations. Reduce deadlines and supply an undisputable level of quality.

Determined to improve working conditions, we are committed under the **Safety/Hygiene/Health** aspect to ensure the conformity of the equipment and the work environment to the rules and regulations.

Ensuring the preservation of the **Environment** for the present and future generations means that we have to guarantee the conformity of the site and the products to the regulations by reducing our consumptions of resources and our rejects. Focusing on and improving the positive impact of our products on the environment by contributing to the reduction of polluting emissions and organizing recovery and recycling of our worn products.

For the **Social** aspect, in a spirit of perfect equity, we take care of the expectations of our employees. We are committed to organizing and maintaining a structured "listen to" approach to respond to the expectations of

each one according to the work code and the collective wage agreement of the rubber industry.

Through our **Company commitment**, we should grasp better the incidences of our national setup. We have to establish relations with communities to inform them about and intensify our missions and those of our representatives. Grow to exist : this is the



Economic driving force for any company faced with a strong competition sometimes at the international level. Investing in competences and leading edge technologies is a guarantee of strong growth.

Following the principles of transparency and the respect for rules, we formalize our approach to ensure our development through commercial and communication actions in order to enhance our notoriety on target markets.

EFJM IN NUMBERS

Year	Turnover € Millions	Manpower
2006-2007	2,500	20
2005-2006	2,260	19
2004-2005	2,180	19

Annual investment on revenues: 10 %

Clientele structure per market:

- 1 Food/agriculture 55 %
- 2 Pneumatic (jacks, distributors) 20 %
- 3 Aeronautics/military 10 %
- 4 Miscellaneous 15 %

